

alupress
ALUMINIUM
WINDOW SILLS

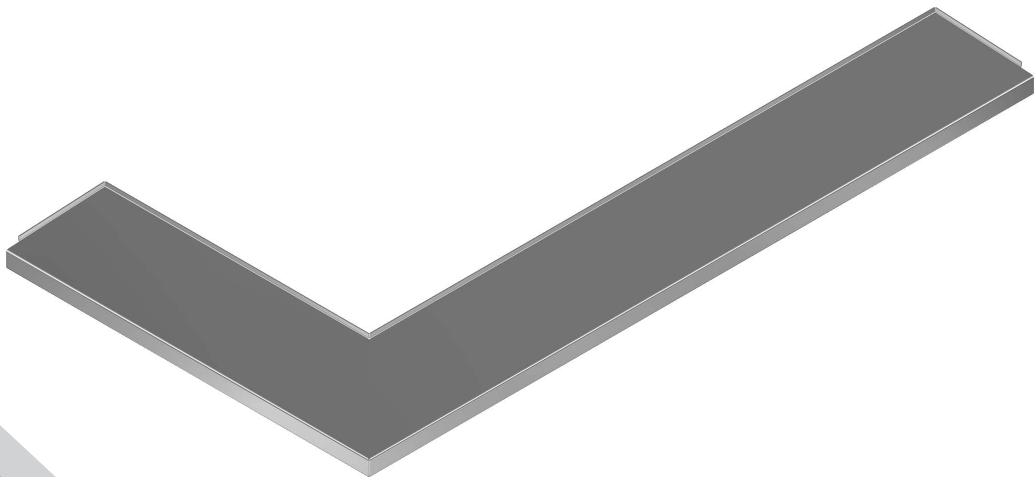

WINDOW SILLS

DATA SHEET

Our window sills are durable, corrosion-resistant components designed to provide a protective and aesthetic finishing touch to window installations. Offering excellent weather resistance, structural support, attractive appearance, making them suitable for various residential, commercial, and industrial applications.

Key Features:

Material: High-grade aluminium

Finish Options: Powder Coated standard range of RAL Colours

Profiles: Available in flat, sloped, or custom profiles

Length Options: Customisable up to 4 meters

Thickness Options: 1.5mm to 3mm

Welded stop ends and upstands

Environmental Resistance: Corrosion-resistant, UV-stable, and weatherproof

Technical Specifications:

Material Composition: Aluminium alloy 1050A

Standard Lengths: Customisable lengths up to 4m

Profile Types

Sloped: Various widths with a standard 5-degree slope

Custom: Tailored to specific architectural requirements

Finish Types:

Powder-Coated: RAL colours available

Performance Characteristics

Durability: High resistance to corrosion, suitable for coastal and industrial environments

Maintenance: Low maintenance, easy to clean

Installation: Pre-drilled fixing holes available on request, easy to install with standard tools

Compatibility: Suitable for use with various window systems, including aluminium, Aluclad, UPVC and timber.

Applications

Residential buildings: Houses and apartments.

Commercial buildings: Offices, retail stores, and hospitality establishments

Industrial buildings: Warehouses, factories, and workshops

Public buildings: Schools, hospitals, and gov facilities

Customisation Options

Dimensions: Custom widths, lengths, and profiles to match specific project requirements

Colours: Wide range of RAL colours to match building aesthetics

Accessories: Welded end caps and upstands, welded corner pieces.

Installation Guidelines:

1. Measure and cut the aluminium window sill to the required length.
2. Pre-drill fixing holes if not pre-drilled.
3. Apply a weather-resistant sealant to the back edge of the sill.
4. Position the sill under the window frame and secure it with screws through the pre-drilled holes.
5. Seal all joints and edges with appropriate sealant to ensure a watertight installation.

Maintenance Instructions

Clean with mild soapy water using a soft cloth

Avoid abrasive cleaners/tools that may harm surface

Inspect periodically for any signs of blockage, damage, or wear and clear debris as necessary.

This data sheet provides essential information about our aluminium window sills, ensuring you have all the details needed for your project. For further assistance or to place an order, please contact our customer service team.