

# ALUMINIUM SECRET FIX CAPPINGS

Aluminium secret fix cappings are designed to provide a sleek, continuous finish to parapet and boundary walls while concealing fixings for a clean and modern appearance. These cappings offer excellent weather resistance, durability, and low maintenance, making them ideal for various architectural applications.

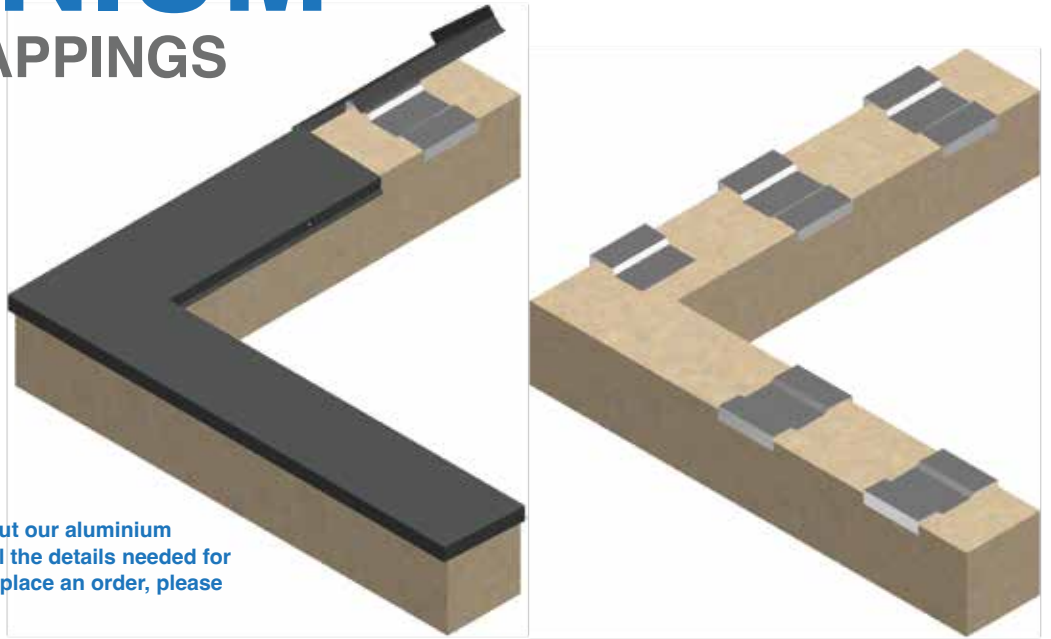

This data sheet provides information about our aluminium secret fix cappings, ensuring you have all the details needed for your project. For further assistance or to place an order, please contact our customer service team.

## ACCESSORIES:

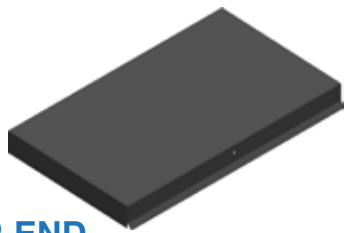

WELDED STOP-END



WELDED CORNER

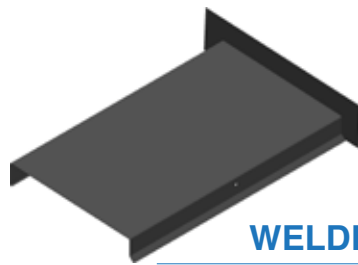

WELDED UPSTAND

# SECRET FIX CAPPINGS

## DATA SHEET

### Key Features:

- Material:** High-grade aluminium  
**Finish Options:** Powder coated in various colours  
**Profiles:** Sloped, or custom profiles  
**Lengths:** Customizable up to 4 meters  
**Thickness Options:** 2mm to 3mm  
**Fixing Method:** Concealed (secret fix) system 3mm aluminium brackets or 2mm thick galvanised brackets.

### Technical Specifications

- Material Composition:** Aluminium alloy 1050A  
**Standard Lengths:** customisable lengths up to 4mT  
**Profile Types**  
**Sloped:** Standard widths from 100mm to 400mm with a standard slope  
**Custom:** Tailored to specific architectural requirements  
**Finish Types:** Powder-Coated: RAL colours available  
**Performance Characteristics:**

### Performance Characteristics

- Durability:** High resistance to corrosion.  
Maintenance Low maintenance, easy to clean  
**Weather Resistance:** Excellent resistance to UV, rain, and temperature fluctuations  
**Installation:** Concealed fixing system ensures a clean, seamless look with no visible fasteners  
**Compatibility:** Suitable for use with various wall materials, including brick, stone, and rendered surfaces

### Applications

- Residential buildings:** Houses, apartments.  
**Commercial buildings:** Offices, retail stores, and hospitality establishments  
**Industrial buildings:** Warehouses, factories, and workshops  
**Public buildings:** Schools, hospitals, and gov facilities

### Customisation Options

- Dimensions:** Custom widths, lengths, and profiles to match specific project. **Colours:** Wide range of RAL colours to match building aesthetics. **Accessories:** Welded corners, welded stop ends, welded upstands.

### 1. SCOPE AND PURPOSE

This guide provides detailed instructions for the installation of aluminum secret fix parapet cappings to ensure a secure, weatherproof, and visually seamless finish while accommodating thermal movement and maintaining durability.

### 2. PREPARATION

#### 2.1 Site Inspection

This guide provides detailed instructions for the installation of aluminum secret fix parapet cappings to ensure a secure, weatherproof, and visually seamless finish while accommodating thermal movement and maintaining durability.

#### 2.2 Materials and Tools

##### Materials:

- Aluminum secret fix cappings
- Secret fix brackets/clips
- Silicone sealant/adhesive (weatherproof & UV resistant)
- Corrosion-resistant fixings (screws or rivets)

##### Tools:

- Cordless drill with appropriate bits
- Spirit level •Measuring tape •Rubber mallet
- Cleaning materials (non-abrasive cleaner or alcohol-based solvent)
- Sealant applicator
- PPE: gloves, safety glasses

#### 2.3 Cleaning

- Clean the parapet surfaces and capping sections to remove any grease, oil, or dirt.
- Allow the surfaces to dry completely before installation.

#### 2.4 Thermal Movement Considerations

- Allow for thermal expansion by following manufacturer-recommended expansion gaps (typically 1mm per meter of capping).

# ALUMINIUM SECRET FIX CAPPINGS INSTALLATION GUIDE

## 3. INSTALLATION PROCESS

### 3.1 Fixing Clip Installation

Mark the position of the fixing clips along the parapet at the recommended intervals (typically 600–1000 mm centers). Secure the clips to the parapet using corrosion-resistant screws or appropriate anchors for the substrate.

### 3.2 Installing the Cappings

- Apply 2 continuous beads of MS-polymer based adhesive sealant (Parabond 600 or similar) to the joint plate and insert to one end of the first aluminium capping.
- Position the first aluminium capping section over the parapet, aligning it with the fixing bracket, ensuring a bracket is positioned at the joint. and fix to brackets using suitable self drilling screws on the inside of the parapet.
- Apply 2 continuous beads of MS-polymer based adhesive sealant (Parabond 600 or similar) to the exposed end of the joint plate.
- Position the next capping section adjacent to the installed one, clip onto the brackets leaving the specified expansion gap and fix accordingly ensuring it aligns seamlessly.

## 4. FINISHING

### 4.1 Final Sealing

- Smooth exposed sealant with a spatula or finger dipped in soapy water for a clean, professional finish.
- Remove excess sealant to maintain a neat appearance

### 4.2 Cleaning

- Wipe down the capping sections with a non-abrasive cleaner to remove fingerprints, sealant residue, or dirt.

### 4.3 Inspection

- Check all cappings for alignment, secure fixing, and uniform joint gaps.
- Confirm all joints are weatherproof and visually seamless.

## 5. Maintenance & Care

### Regular Inspections

- Inspect the cappings periodically for signs of wear, sealant degradation, or movement.

### Repairs

- Replace or re-seal any damaged or compromised joints as needed

### Cleaning

- Clean the cappings regularly using non-abrasive materials to maintain their appearance and longevity

**By following this guide, you can ensure the successful installation of aluminium secret fix cappings that are both functional and aesthetically pleasing.**

