



alupress

www.alupress.ie

HALF ROUND Extruded Gutters

Manufactured in-house, our aluminium gutter systems offer clean lines, reliable drainage, and low maintenance for residential and commercial buildings, with durable powder coating and consistent lead times across Ireland and the UK.

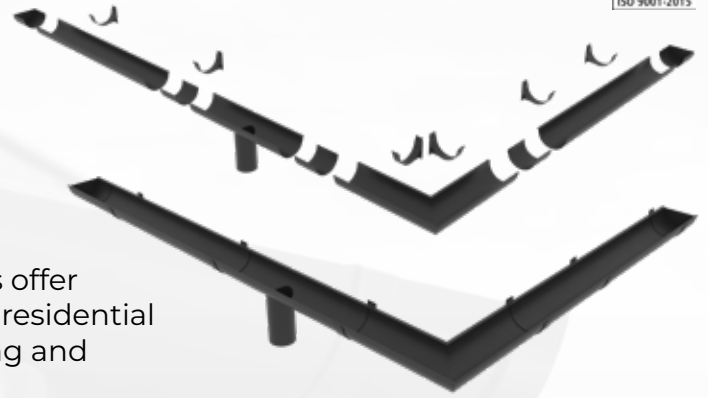

Ø 125mm HALF ROUND EXTRUDED GUTTER

Dimensions: Ø 125mm x 3m

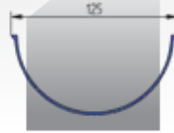

STANDARD RAL COLOURS



INTERNAL & EXTERNAL CORNERS

Angle: 90° | 135° | Bespoke



STANDARD RAL COLOURS



RUNNING OUTLETS

Dimensions: Ø 76.2mm | 101.6mm



STANDARD RAL COLOURS



CLIP FIX BRACKETS

If further information is required
please contact: info@alupress.ie



STANDARD RAL COLOURS



LOOSE STOP ENDS

STANDARD RAL COLOURS

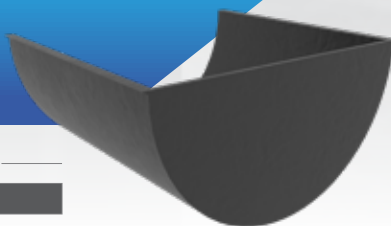

GUTTER JOINTERS

STANDARD RAL COLOURS

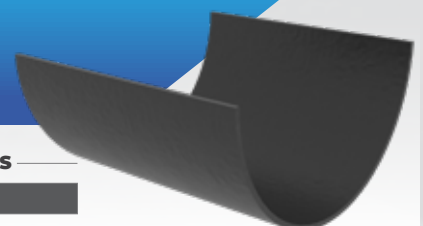

BOX/SQUARE Aluminium Gutters

Designed for reliable rainwater management and a clean architectural appearance, our aluminium gutter systems are corrosion resistant, low maintenance and suitable for modern building designs.

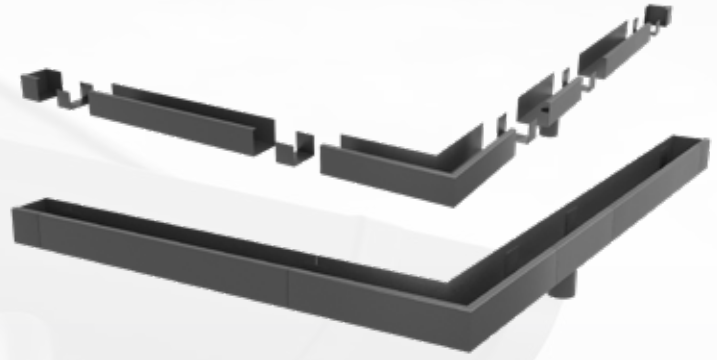

**100x125x100mm
BOX GUTTER**

Other sizes available on request





**INTERNAL & EXTERNAL
CORNERS**

Various angles available on request



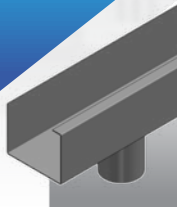

**RUNNING
OUTLETS**

Square or round spigots





**LOOSE
STOP END**

If further information is required
please contact: info@alupress.ie



**GUTTER
JOINTERS**

If further information is required
please contact: info@alupress.ie



GUTTERS DATA SHEET

Aluminium gutters are designed to efficiently collect and direct rainwater away from the building structure, preventing water damage and maintaining the integrity of the building. Durability, low maintenance, and aesthetic appeal, aluminium gutters are ideal for various residential, commercial, and industrial applications.

Key Features:

- Material:** High-grade extruded aluminium
- Finish Options:** Powder Coated in various colours
- Profiles:** Available in 125mm half-round, and box profiles various sizes.
- Lengths:** Standard 3m lengths
- Thickness Options:** 1.5mm to 3mm
- Environmental Resistance:** Corrosion-resistant, UV-stable, and weatherproof

Technical Specifications:

- Material Composition:** Aluminium alloy 6063/6061
- Standard Lengths:** Standard 3m lengths
- Profile Types**
 - Round** - Diameters from 75mm to mm
 - Square** - Sizes from 75mm x 75mm to 150mmx150mm
 - Rectangular** - Custom sizes available on request
- Finish Types:** Plain mill finish
Powder-Coated: RAL colors available

Performance Characteristics

- Durability:** High resistance to corrosion.
- Maintenance:** Low maintenance, easy to clean
- Weather Resistance:** Excellent resistance to UV, rain, and temperature fluctuations
- Installation:** Easy to install with standard brackets and accessories
- Compatibility:** Suitable for use with various roofing systems and gutter types

Applications

- Residential buildings:** Houses, apartments.
- Commercial buildings:** Offices, retail stores, and hospitality establishments
- Industrial buildings:** Warehouses, factories, and workshops
- Public buildings:** Schools, hospitals, and gov facilities

Customisation Options

- Dimensions:** Custom diameters, lengths, and profiles to match specific project requirements
- Colours:** Wide range of RAL colours to match building aesthetics
- Accessories:** Matching brackets, connectors, bends available

Installation Guidelines:

1. Measure and cut the aluminium gutters to the required length.
2. Attach brackets to the fascia board at regular intervals (approximately 1 meter apart).
3. Secure the gutters to the brackets, ensuring a slight slope for water flow towards the downpipes.
4. Connect the gutter sections using appropriate connectors and seal joints with weatherproof sealant.
5. Attach end caps to the gutter ends and install outlets for connecting to downpipes.
6. Ensure all joints are sealed properly to prevent leaks and check alignment for proper water flow.

Maintenance Instructions

Clean with mild soapy water using a soft cloth
Avoid abrasive cleaners/tools that may harm surface
Inspect periodically for any signs of blockage, damage, or wear and clear debris as necessary.

This data sheet provides essential information about our aluminium downpipes, ensuring you have all the details needed for your project. For further assistance or to place an order, please contact our customer service team.

